

*Down the East side of the Island.*

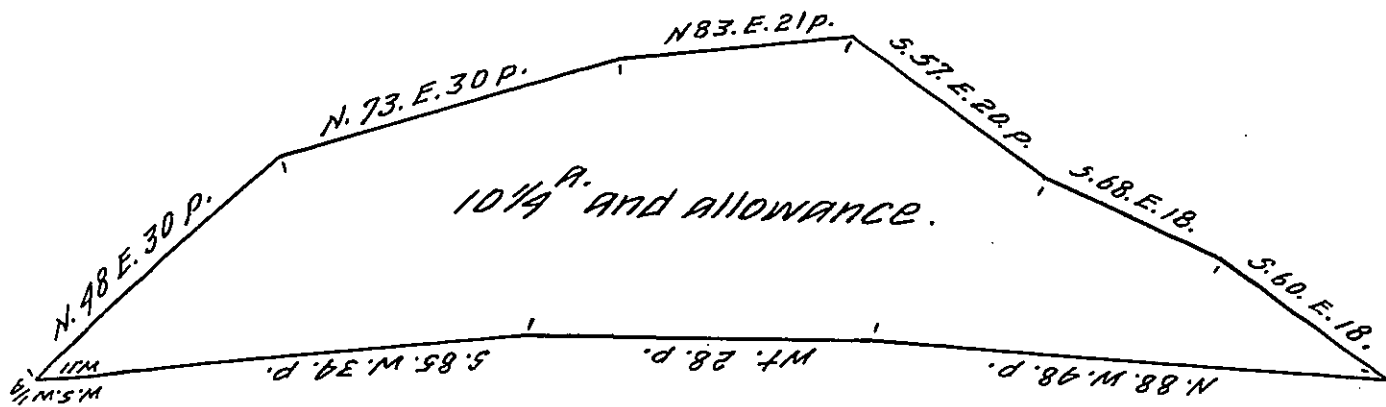

*Thence up the west side of the Island.*

*Surveyed for the use of the Hble. the Proprietors on the 16th. May 1771. the above Described Island Containing ten acres and one quarter and the allowance of six p. Ct. Situate in the River Susquehanna opposite to Land appropriated by Samuel Lanken on the west side of the said River in Cumberland County by their warrant of the 13th. Day of October. 1760.*

*p. Bartrem Galbraith D.S.*

*To John Lukens Esqr. Surveyor Genl.*

IN TESTIMONY that the above is a copy of the original remaining on file in the Department of Internal Affairs of Pennsylvania, made conformably to an Act of Assembly approved the 16th day of February, 1833, I have hereunto set my Hand and caused the Seal of said Department to be affixed at Harrisburg, this *twenty seventh* day of *January* 1910

*Henry Howell*  
Secretary of Internal Affairs.